

Warehouse ~ For Sale



Hobbs Associates, Inc.
Commercial/Industrial Real Estate

For More Information Call:

Brian Hobbs

BHobbs@TheWarehouseBroker.com

301-937-2188



10776 Tucker Street, Beltsville, MD 20705

- 5,522 +/- Sq. Ft.—Clear Span Building
- Condominium Condo, Condo Fee \$40/month
- Self Contained— Separate Metered Utilities
- Dock High—Loading Platform & Drive-up ramp
- Zoned – I-2 (Heavy Industrial)
- Low Maintenance ~ All Brick
- Asking Price \$795,000.00
- Two Traffic Lights from Beltway via U.S. 1
Or Kenilworth Avenue, Exit #23
- Call to schedule a tour

The information contained herein has been given to us by the owner of the property or obtained from sources we deem reliable. No warranty or representation, express or implied, is made as to the accuracy of the information contained herein, and same is submitted subject to errors, omissions, change of price, sale or other conditions, withdrawal without notice and to any special listing conditions imposed by our principals.

10776 Tucker Street ~ Site Plan



Hobbs Associates, Inc.
Commercial/Industrial Real Estate

For More Information Call:

Brian Hobbs

BHobbs@TheWarehouseBroker.com

301-937-2188

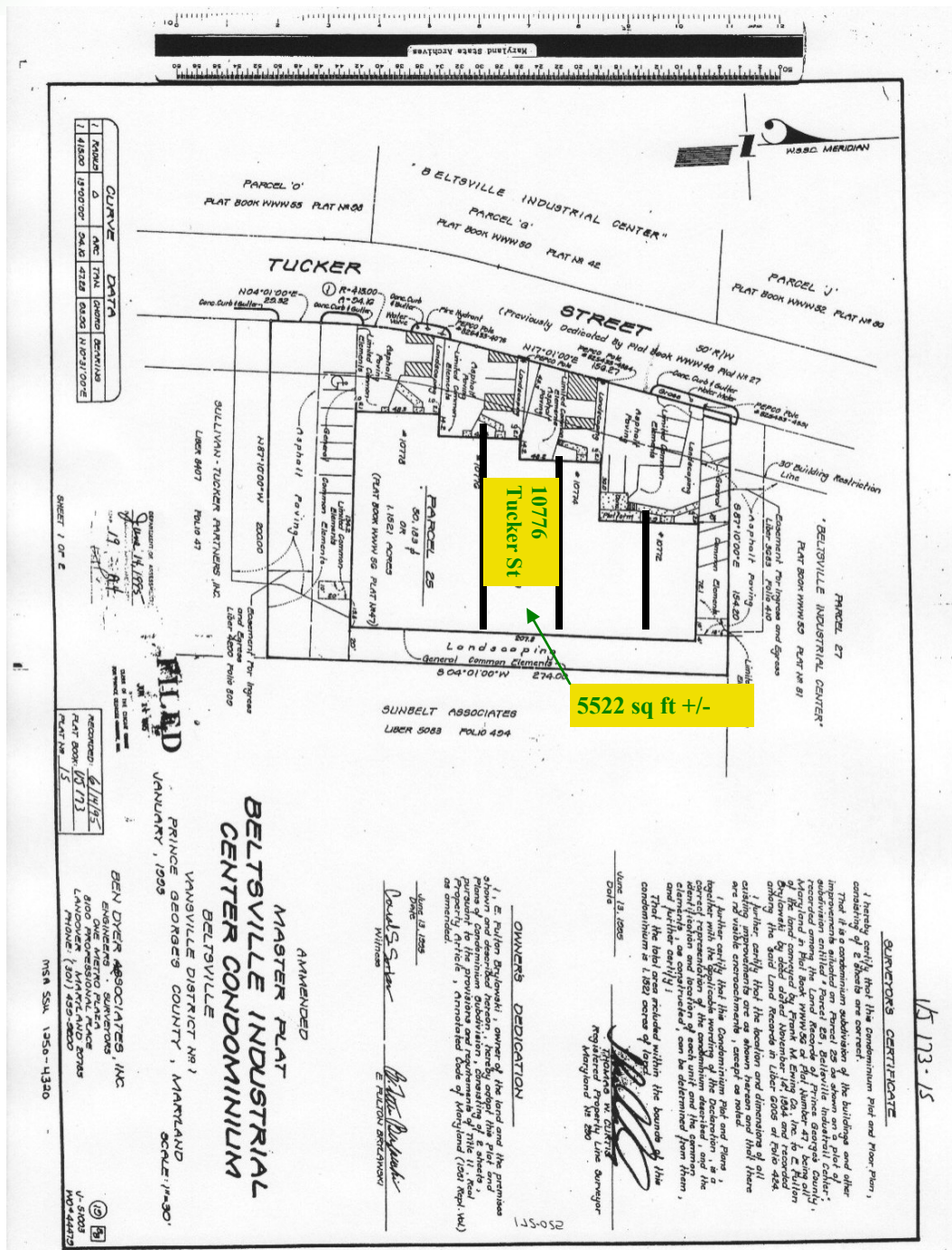

The information contained herein has been given to us by the owner of the property or obtained from sources we deem reliable. No warranty or representation, express or implied, is made as to the accuracy of the information contained herein, and same is submitted subject to errors, omissions, change of price, sale or other conditions, withdrawal without notice and to any special listing conditions imposed by our principals.